



LA INDUSTRIA DE LA CERRAJERÍA

Cam locks / Standard 137

Descripción

CYLINDERS AND LOCKS Cylinder for doors up to 23 mm thick with great versatility in terms of rotation directions and key exit positions. With the possibility of master keying, equalization, and grouping.

KEY MODEL		AGA-12I
MATERIAL	Brass	
FINISHES	Chromed	
	Polishing	
FEATURES	L = 20,4 mm / R = 15,4 mm	
	L = 28,1 mm / R = 23,1 mm	
	Number of combinations: 3120	
	No. of Master Combinations: consult	
	Weight (g): 83	
ACCESORIES	M19x1 nut	
	Metal washer	
	Lock washer	
	M10x1 nut	

*AGA supplies the cylinder in chrome finish as standard, right-hand rotation, one keyhole, and with 2 keys.

*Other cylinder lengths supplied on request.

Fotos

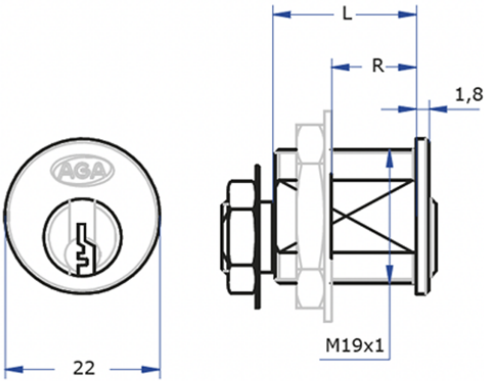

LA INDUSTRIA DE LA CERRAJERÍA

Dimensiones del orificio

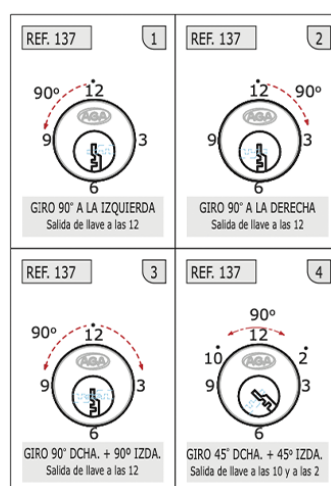
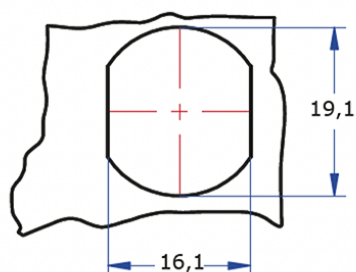

LA INDUSTRIA DE LA CERRAJERÍA

S	LENGÜETAS LISAS													
H	15	20	25	30	35	40	45	50	55	60	65	70	75	

Ejemplo de pedido: S-20

S LENGÜETAS CURVAS								
H	35	G	3	5	10	15	20	25
H	55	G	5	10	15	20	25	30

Ejemplo de pedido: Indicar la posición del cierre.
Cerrado a las 12 y 6 cajón: S-35-3-C
Cerrado a las 9 y 3, armario: S-35-5-A

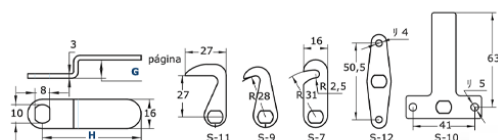

LA INDUSTRIA DE LA CERRAJERÍA