



LA INDUSTRIA DE LA CERRAJERÍA

Pushbutton Lock 510

Descripción

CYLINDERS AND LOCKS _ Sliding doors blocking pushbutton lock. Lock models 510 and 780 are used for vending machines. Same code locks (KA) groups options available.

MATERIAL	Brass Cylinder
	Zamak Cylinder
FINISH	Brass-plated
FEATURES	L = 40 mm
	Number of combinations: 3120
	Weight (g): 66

*AGA supplies as standard this model chromium plated with key removable at one position and 2 keys.

*Different extension lengths available upon request.

Fotos

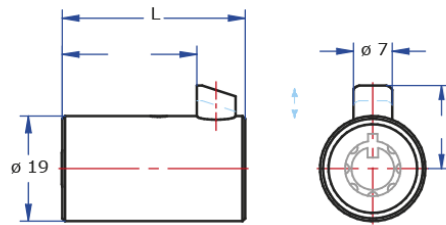

780



LA INDUSTRIA DE LA CERRAJERÍA