

1206 Bolt Lock, Laua Series

Lock for double manoeuvre, encoded to combine with other safety locks. Bolt works in both positions, extended and retracted. Key is free when bolt is extended. When bolt is retracted, key is trapped and the mechanism is locked. To start the sequence in standard manoeuvre, the key in the second lock has to be trapped.

MANOEUVRE		BOLT		CODE
	LENGHT	THROW	THREAD	
STANDARD	18	13	NO	UP1206I0F1

STANDARD MANOEUVRE

INITIAL POSITION Bolt extended Key n° 1 free Key n°2 trapped	POSITION AFTER MANOEUVRE Bolt retracted Key n° 1 trapped Key n°2 free
--	---

Categorías: [Industry Energy transformation](#), [Bolt Locks](#), [Laua series bolt locks](#)

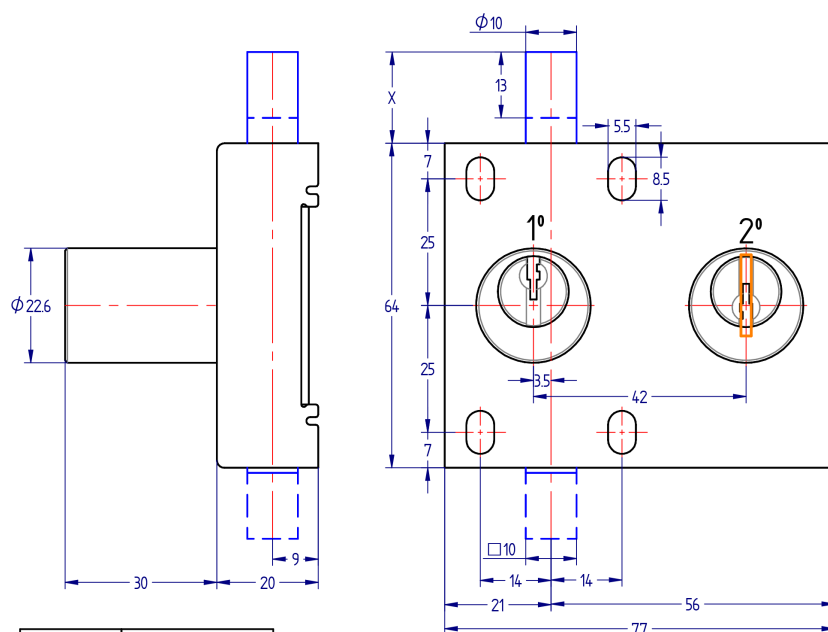

PALANCA	CARRERA	
X	X max	X min
18	18	5
35	35	22