



LA INDUSTRIA DE LA CERRAJERÍA

Borobil series bolt lock 7201

Descripción

Lock for double manoeuvre, encoded to combine with other safety locks. Bolt works in both positions, extended and retracted. Key is free when bolt is extended. When bolt is retracted, key is trapped and the mechanism is locked. When bolt is retracted the switch is activated.

MANOEUVRE		BOLT		CODE
	LENGHT	THROW	THREAD	
STANDARD	18	13	NO	UT7201I0F0
STANDARD	35	13	NO	UT7201I0F01
INVERSE	18	13	NO	UT7201I0D0
INVERSE	35	13	NO	UT7201I0D01

STANDARD MANOEUVRE

--	--

INVERSE MANOEUVRE

--	--

Fotos

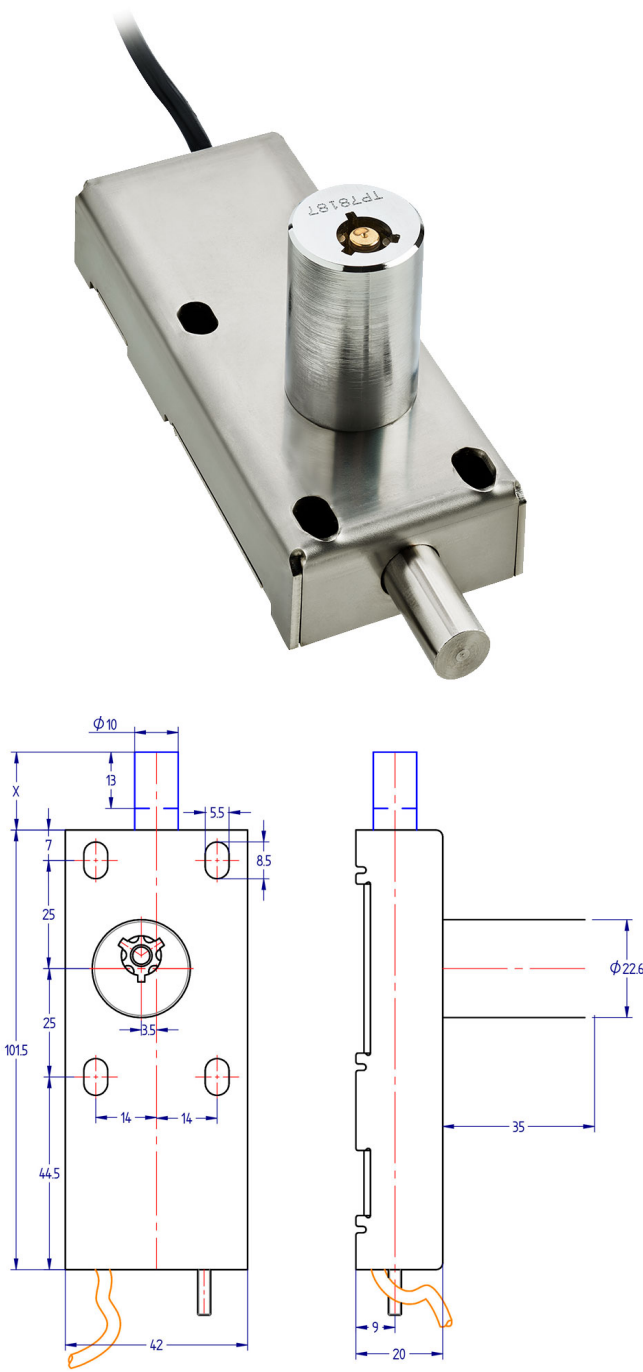

LA INDUSTRIA DE LA CERRAJERIA