



LA INDUSTRIA DE LA CERRAJERÍA

## M22 407 Quarter Turn Latches

### Descripción

Quarter turn latches for doors with a thickness between 6 and 57mm (see R). Designed for use in harsh climate conditions or when IP-rating is required.

AGA supplies as standard L=18mm, R=6 or 8mm, with Z-150 cam and without key except in the model 400, which is supplied with 59DP or 8705 key model (page 9). Further measurements upon request.

<b>KEY FORM</b>	Square 8 mm
<b>MATERIAL</b>	Black polyamide (fireproof)
<b>FINISH (zamak)</b>	-
<b>FEATURES</b>	L = 18 mm / R = 6 mm
<b>WEIGHT(grams)</b>	46
<b>LOCKING DIRECTION</b>	90° Left/Right
<b>IP-RATING</b>	-
<b>ACCESORIES</b>	M22 Nut, M22 metallic washer, M22 plastic washer
<b>KEY</b>	3018C

Fotos

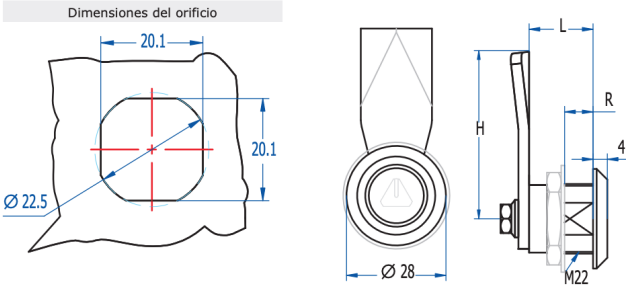

LA INDUSTRIA DE LA CERRAJERÍA

Otros Accesorios:



**Tapa protectora**  
Accesorios: página 63.

LENGÜETAS								
Z	Z150	Z151	Z152	Z153	Z157	Z158	Z159	Z160
H	47	52	57	62	47	47	47	47
G	-	-	-	-	5	10	15	20

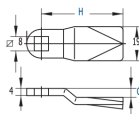

LA INDUSTRIA DE LA CERRAJERÍA