

Home > Industry Energy transformation > Bolt Locks > Laua series bolt locks > 1227 Bolt Lock, Laua Series

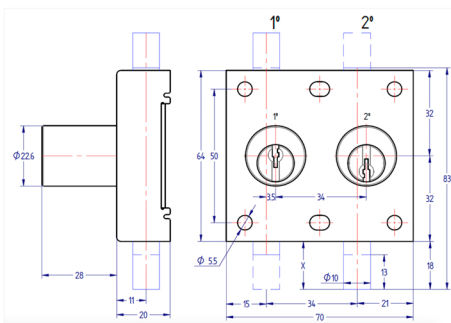

1227 Bolt Lock, Laua Series

Lock for double manoeuvre, encoded to combine with other safety locks. Bolts work in both positions, extended and retracted. Key is free when bolt is extended. When bolt is retracted, key is trapped and the mechanism is locked. To start the sequence in standard manoeuvre, the key in the second lock has to be trapped.

MANOEUVRE	BOLT			CODE
	LENGHT	THROW	THREAD	
STANDARD	18	13	NO	UP1227IOF1

STANDARD MANOEUVRE

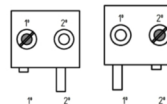

INITIAL POSITION

Bolt nº1 extended
 Bolt nº2 retracted
 Key nº1 trapped
 Key nº2 free

POSITION AFTER MANOEUVRE

Bolt nº1 retracted
 Bolt nº2 extended
 Key nº1 trapped
 Key nº2 free

