

Home > Industry Energy transformation > Bolt Locks > Borobil series bolt locks > 7226 Bolt Lock, Borobil Series

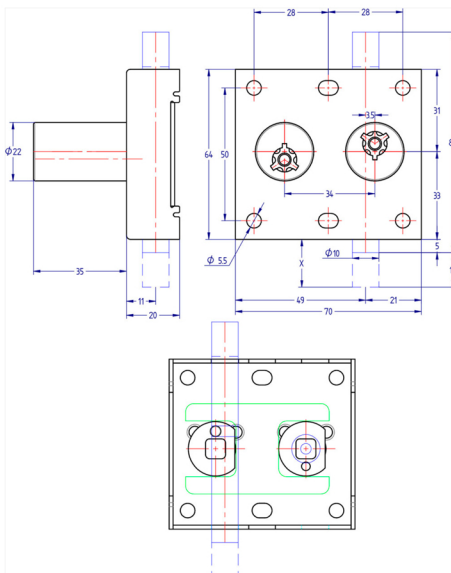

7226 Bolt Lock, Borobil Series

Lock for double manoeuvre, encoded to combine with other safety locks. Bolt works in both positions, extended and retracted. Key is free when bolt is extended. When bolt is retracted, key is trapped and the mechanism is locked. To start the sequence in standard manoeuvre, the key in the second lock has to be trapped.

| MANOEUVRE | BOLT | | CODE | |
|-----------|--------|-------|--------|----------|
| | LENGHT | THROW | THREAD | |
| STANDARD | 18 | 13 | NO | U7226001 |